



# 130 SHEPARD ST

LAWRENCE, MA

---

10,500 SF | FLEX INDUSTRIAL SPACE FOR LEASE

DANNY CRUZ  
NICHOLAS STUBBLEBINE

978.305.0473  
857.362.9603

[danny@stubblebinecompany.com](mailto:danny@stubblebinecompany.com)  
[nick@stubblebinecompany.com](mailto:nick@stubblebinecompany.com)



THE  
STUBBLEBINE  
COMPANY

CORFAC INTERNATIONAL

# PROPERTY SUMMARY

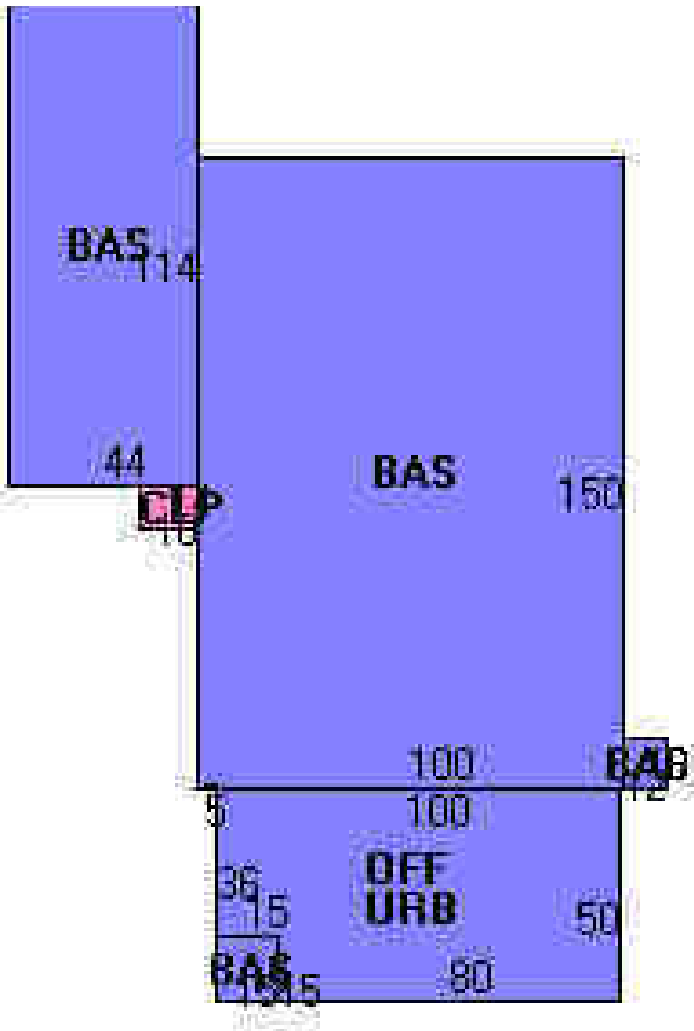

## PROPERTY HIGHLIGHTS

- 1.5 Miles to I-93 & 2 Miles to I-495
- Multiple loading options
- Industrial Park
- Ample Power
- Clear Height up to 18'
- Ideal space for Data Storage

## OFFERING SUMMARY

Lease Rate:	Market
Number of Units:	2
Available SF:	10,500 SF
Building Size:	24,884 SF
Clear Height:	15'-18' (Warehouse) 77" (Lower level -Office)
Loading:	2-Tailboard 1- Overhead
Power:	1,200 Amps   3-Phase

ADDITIONAL PHOTOS



# LOCATION MAP

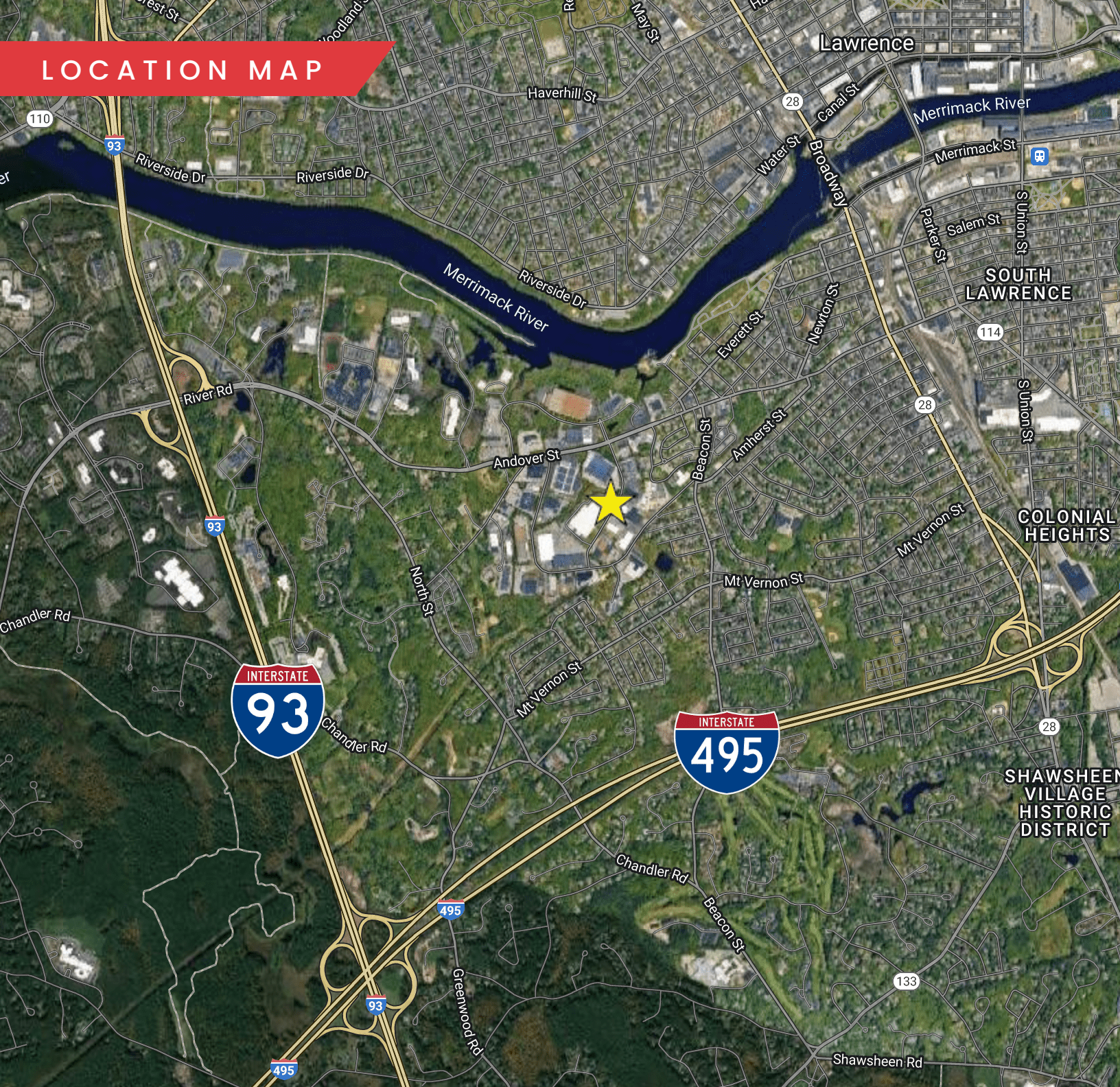

DEMOGRAPHICS	2 MILES	4 MILES	6 MILES
Total population	58,197	164,406	228,625
Median age	34.8	36.2	38.1
Median age (Male)	33.6	34.9	36.6
Median age (Female)	36.7	38.1	39.9
Total households	21,203	58,873	83,396
Total persons per HH	2.7	2.8	2.7
Average HH income	\$81,314	\$93,905	\$106,037
Average house value	\$306,278	\$353,734	\$378,092

130 SHEPARD ST  
LAWRENCE, MA

10,500 SF | FLEX INDUSTRIAL SPACE FOR LEASE

DANNY CRUZ

978.305.0473

[danny@stubblebinecompany.com](mailto:danny@stubblebinecompany.com)

NICHOLAS STUBBLEBINE

857.362.9603

[nick@stubblebinecompany.com](mailto:nick@stubblebinecompany.com)

We obtained the information above from sources we believe to be reliable. However, we have not verified its accuracy and make no guarantee, warranty or representation about it. It is submitted subject to the possibility of errors, omissions, change of price, rental or other conditions, prior sale, lease or financing, or withdrawal without notice. We include projections, opinions, assumptions or estimates for example only, and they may not represent current or future performance of the property. You and your tax and legal advisors should conduct your own investigation of the property and transaction.



THE  
STUBBLEBINE  
COMPANY

CORFAC INTERNATIONAL