



44 MANNING ROAD

BILLERICA, MA

12,000 - 17,872 SF | UNIT 201: FLEX/R&D SPACE FOR LEASE

MICAH STUBBLEBINE
NICHOLAS STUBBLEBINE

978.265.8101
978.202.0167

micah@stubblebinecompany.com
nick@stubblebinecompany.com



THE
STUBBLEBINE
COMPANY

CORFAC INTERNATIONAL

PROPERTY SUMMARY



PROPERTY DESCRIPTION

12,000 – 17,872 SF Flex/R&D Space for Lease

PROPERTY HIGHLIGHTS

- Strategically located near the intersection of Route 3 and Route 62, and has close proximity to Route 128
- This building is a 64,000 SF first class Office/R&D/Light Assembly building
- The passenger/freight elevator has a capacity rating of 4,000 lbs
- Natural gas for the HVAC system heating in Suite 201 is and can be separately metered for that space
- Generator power is also available in Suite 201

OFFERING SUMMARY

Lease Rate:	\$9.95/SF NNN
Available SF:	Unit 201: 12,000 – 17,872
Building Size:	64,000 SF
Zoning:	Industrial
Year Built:	1985
Parking:	2.9/1,000 SF
Loading:	Two (2) shared tailboard docks
Sprinkler:	Wet
Water/Sewer:	City
Main Building Electric:	4,000 amps; 277/480V

ADDITIONAL PHOTOS





ADDITIONAL PHOTOS



FLOOR PLAN

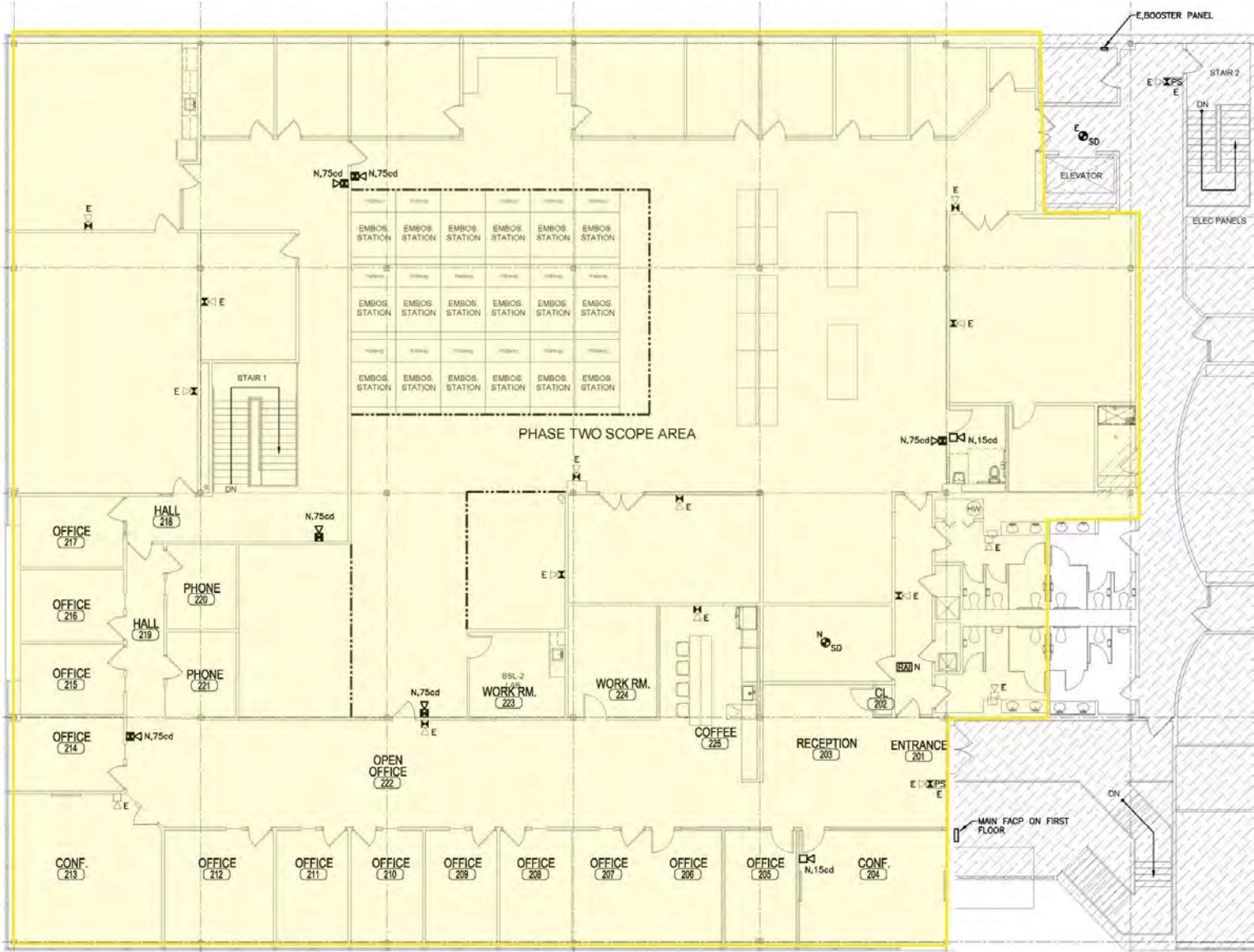

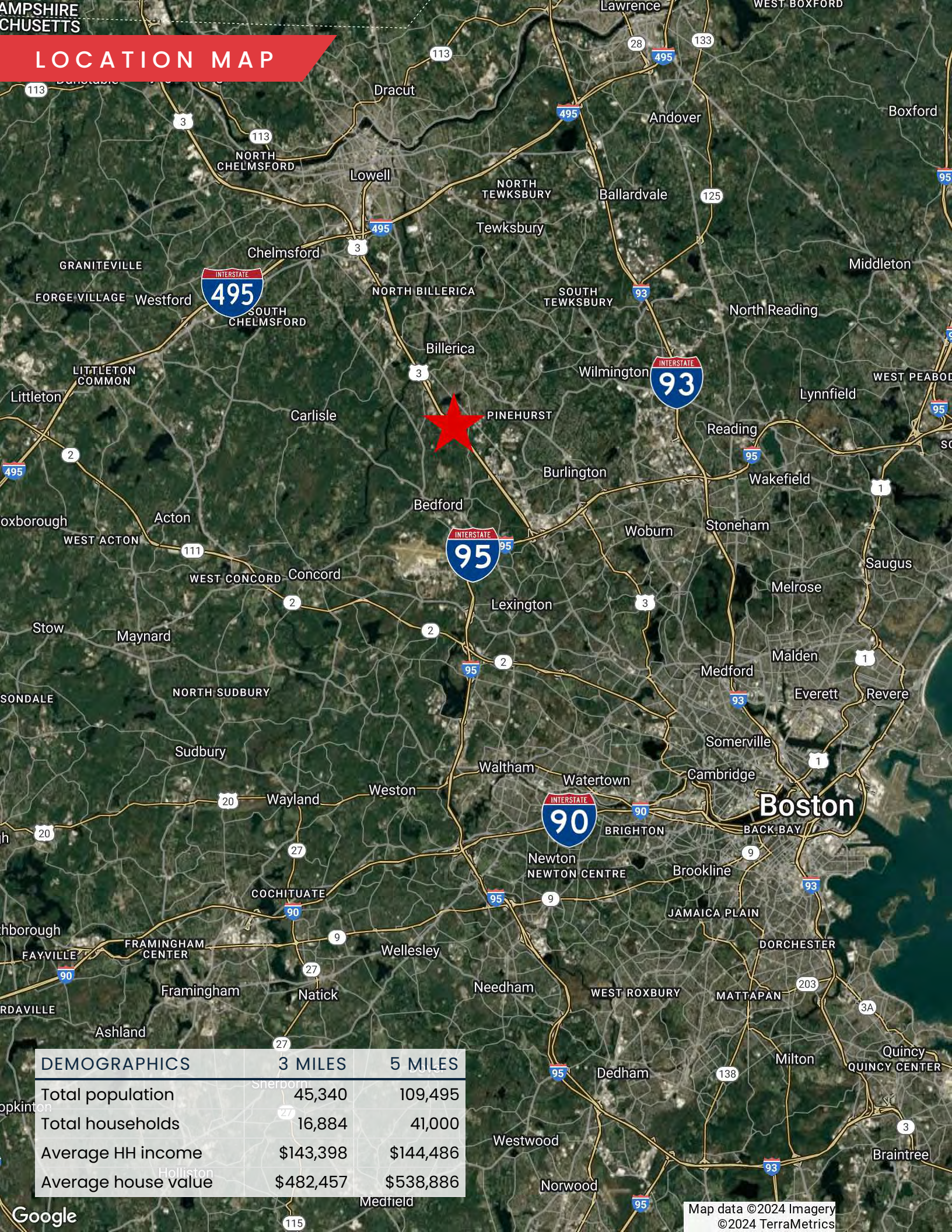

DEMOGRAPHICS	3 MILES	5 MILES
Total population	45,340	109,495
Total households	16,884	41,000
Average HH income	\$143,398	\$144,486
Average house value	\$482,457	\$538,886

44 MANNING ROAD

BILLERICA, MA

12,000 - 17,872 SF | UNIT 201: FLEX/R&D SPACE FOR LEASE

MICAH STUBBLEBINE

978.265.8101

micah@stubblebinecompany.com

NICHOLAS STUBBLEBINE

978.202.0167

nick@stubblebinecompany.com

We obtained the information above from sources we believe to be reliable. However, we have not verified its accuracy and make no guarantee, warranty or representation about it. It is submitted subject to the possibility of errors, omissions, change of price, rental or other conditions, prior sale, lease or financing, or withdrawal without notice. We include projections, opinions, assumptions or estimates for example only, and they may not represent current or future performance of the property. You and your tax and legal advisors should conduct your own investigation of the property and transaction.



**THE
STUBBLEBINE
COMPANY**

CORFAC INTERNATIONAL