

12 INDUSTRIAL DRIVE

STERLING, MA



12,000 SF

22' CLEAR CLASS A
DISTRIBUTION SPACE FOR
LEASE

CONTACT:

ALAN RINGUETTE 978.265.8112
DAVID STUBBLEBINE 617.592.3391
JAMES STUBBLEBINE 617.592.3388
DAVID SKINNER 617.999.0057
JUSTIN HOPKINS 808.321.8000

ALAN@STUBBLEBINECOMPANY.COM
DAVID@STUBBLEBINECOMPANY.COM
JAMES@STUBBLEBINECOMPANY.COM
DSKINNER@STUBBLEBINECOMPANY.COM
JUSTIN@STUBBLEBINECOMPANY.COM

EXCLUSIVE OFFERING



THE
STUBBLEBINE
COMPANY

CORFAC INTERNATIONAL

EXECUTIVE SUMMARY

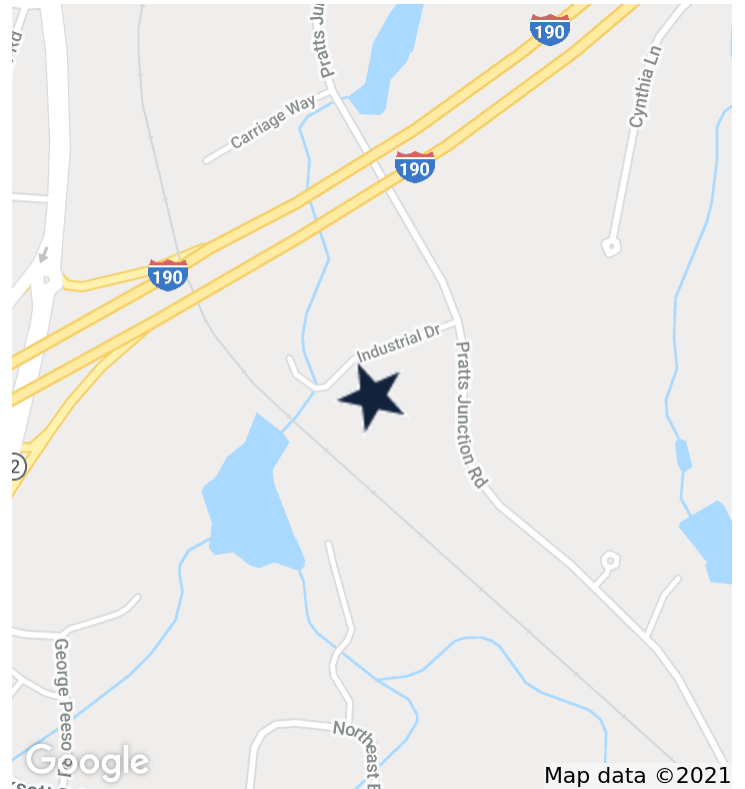

PROPERTY SPECIFICATIONS

LEASE RATE:	MARKET
BUILDING SIZE:	45,150 SF
AVAILABLE SF:	12,000 SF
LOT SIZE:	4.41 ACRES
YEAR BUILT:	1988
ZONING:	LIGHT INDUSTRIAL
CEILING HEIGHT:	22' CLEAR
POWER:	440 AMP/440 VOLT
HEAT:	PROPANE
WATER/SEWER:	TOWN/SEPTIC
SPRINKLER:	WET SYSTEM
LOADING:	2 TAILBOARD
EXPANSION:	POSSIBLE EXPANSION

PROPERTY OVERVIEW

22' CLEAR 12,000 SF SPACE: CLASS A DISTRIBUTION BUILDING

PROPERTY HIGHLIGHTS

- FORMERLY OCCUPIED BY WEETABIX
- 22' CLEAR HEIGHT
- 2 TAILBOARD DOCKS
- CLOSE PROXIMITY TO I-190, ROUTE 2 & ROUTE 12
- 4.5 ACRES
- \$1.44/SF TAXES/OPEX

FLOOR PLAN

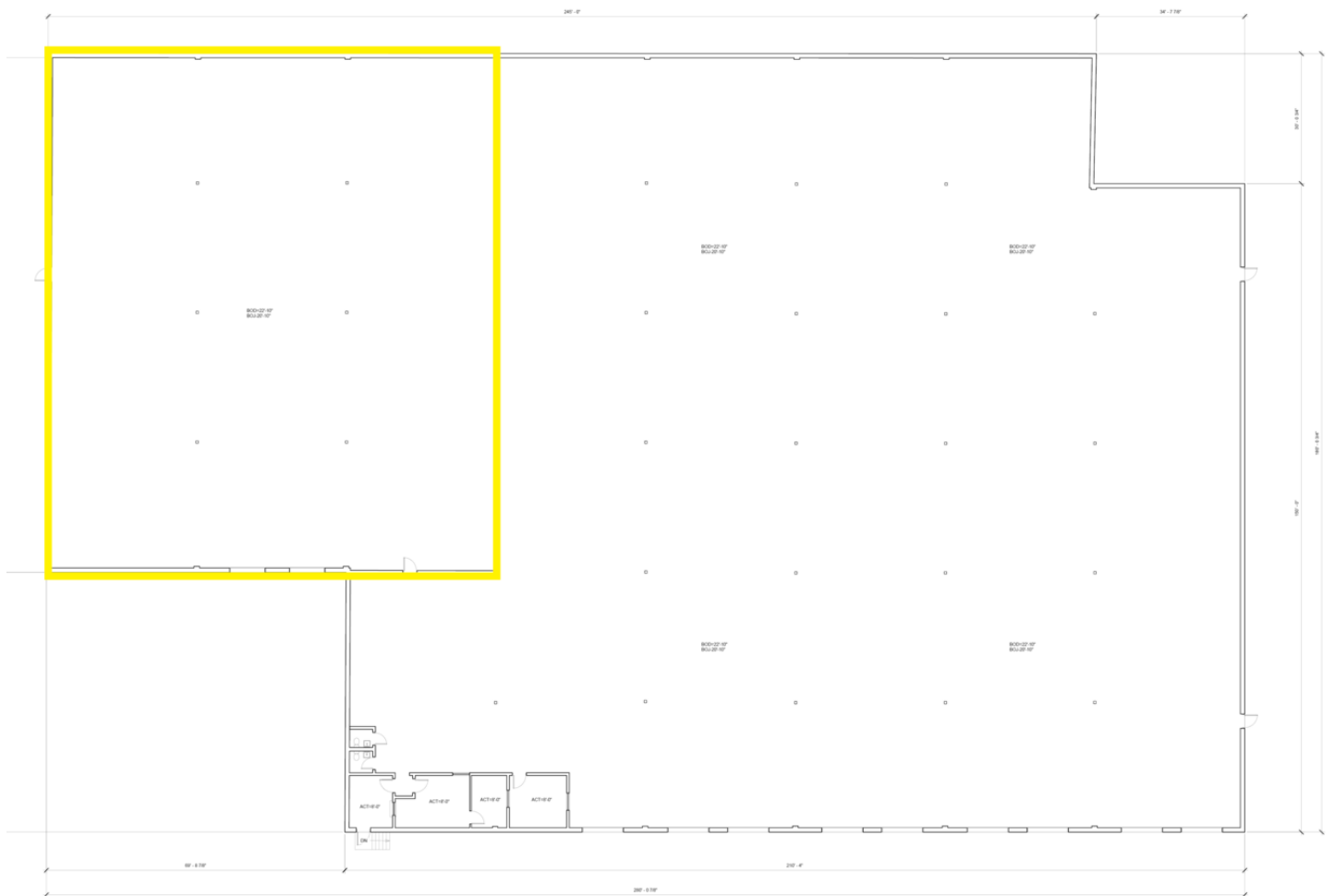

LOCATION MAPS

