

700 TECHNOLOGY PARK DRIVE

BILLERICA, MA



10,078 SF

OFFICE/R&D SPACE AVAILABLE
FOR LEASE

CONTACT:

ELLEN GARTHOFF 978.760.1263
JAMES STUBBLEBINE 617.592.3388
DAVID STUBBLEBINE 617.592.3391
MICAH STUBBLEBINE 978.265.8101

ELLEN@STUBBLEBINECOMPANY.COM
JAMES@STUBBLEBINECOMPANY.COM
DAVID@STUBBLEBINECOMPANY.COM
MICAH@STUBBLEBINECOMPANY.COM

EXCLUSIVE OFFERING



THE
STUBBLEBINE
COMPANY

CORFAC INTERNATIONAL

PROPERTY SUMMARY



PROPERTY DESCRIPTION

10,078 SF of Industrial Office/ R&D space available

DEMOGRAPHICS	3 MILES	5 MILES
TOTAL HOUSEHOLDS	12,469	32,842
TOTAL POPULATION	34,643	92,822
AVERAGE HH INCOME	\$104,379	\$112,011

OFFERING SUMMARY

LEASE RATE:	Market
NUMBER OF UNITS:	5
AVAILABLE SF:	Total: 10,078 SF 2nd Floor: 4,238 SF- Available Now 1st Floor: 5,750 SF- Available 10/1/22
LOT SIZE:	3.09 Acres
BUILDING SIZE:	43,539 SF
YEAR BUILT: RENOVATIONS:	1986 2011
WATER/SEWER:	Town
PARKING:	3.52/1,000 SF
LOADING:	Two (2) loading docks w/ levelers
AMENITIES:	Shower/locker facilities Fitness Center

ADDITIONAL PHOTOS



FLOOR PLANS



5,750 SF - First Floor Space Available 10/1/2022

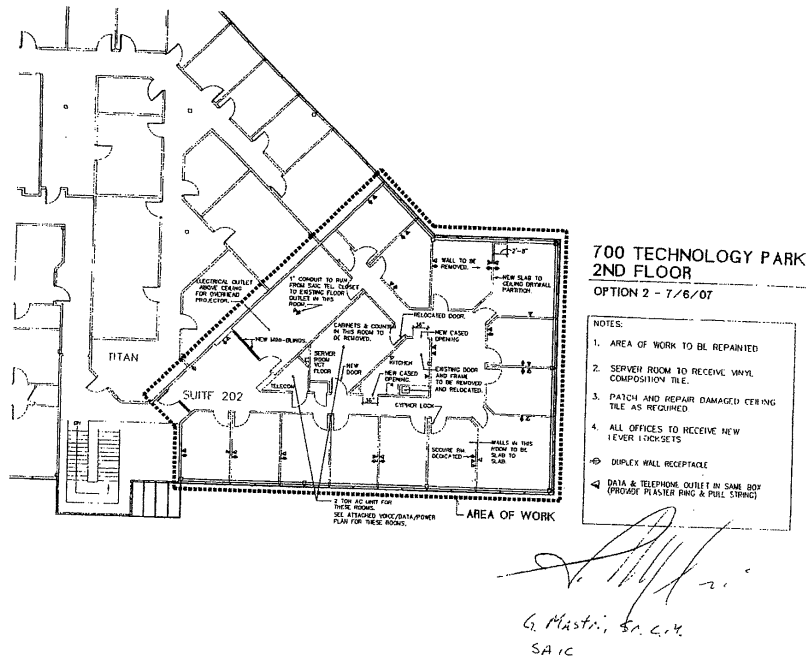

4,328 SF - Second Floor Available Now

LOCATION MAP

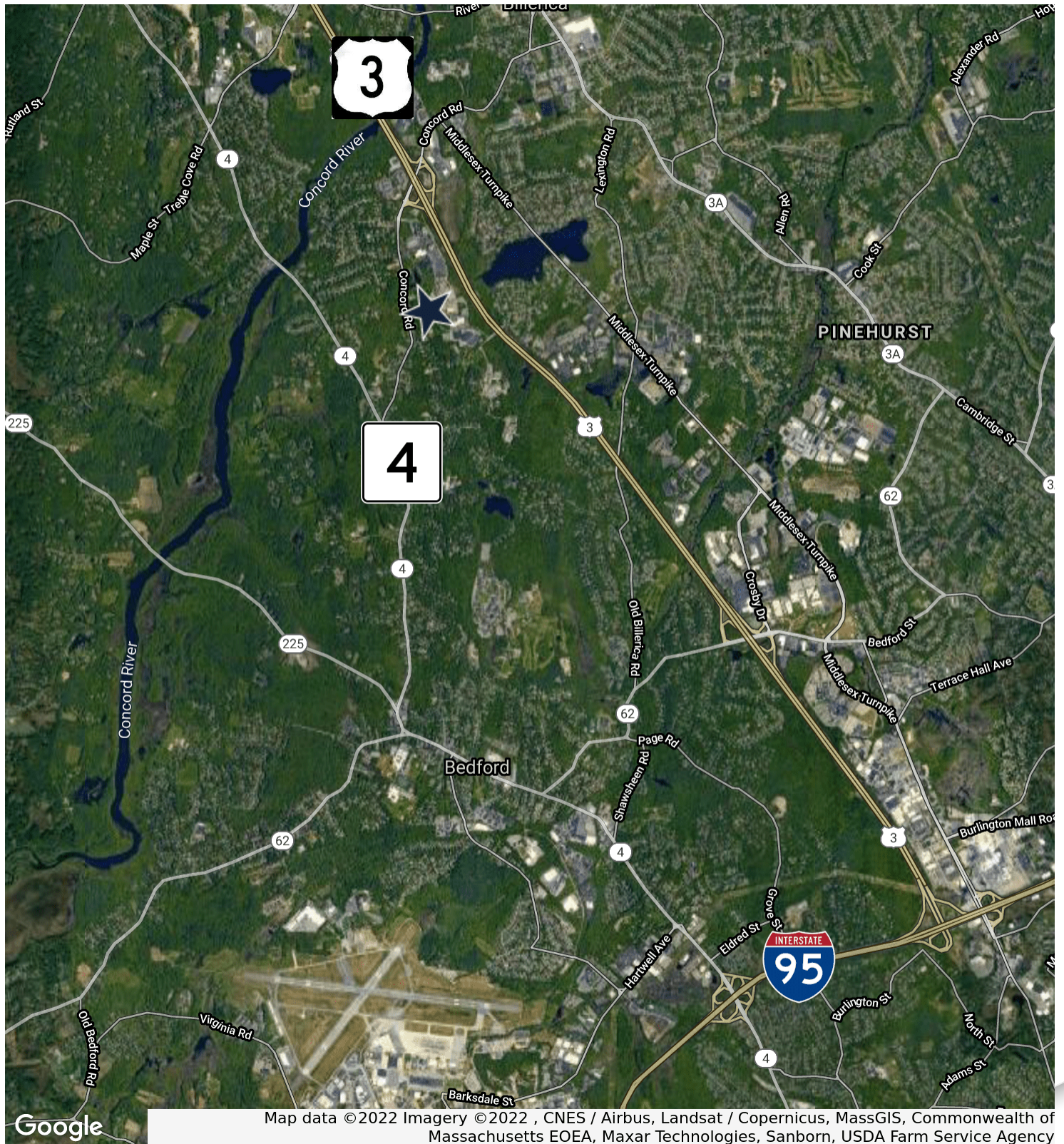

700 TECHNOLOGY PARK DRIVE

BILLERICA, MA



CONTACT:

ELLEN GARTHOFF 978.760.1263
JAMES STUBBLEBINE 617.592.3388
DAVID STUBBLEBINE 617.592.3391
MICAH STUBBLEBINE 978.265.8101

ELLEN@STUBBLEBINECOMPANY.COM
JAMES@STUBBLEBINECOMPANY.COM
DAVID@STUBBLEBINECOMPANY.COM
MICAH@STUBBLEBINECOMPANY.COM

EXCLUSIVE OFFERING



THE
STUBBLEBINE
COMPANY

CORFAC INTERNATIONAL