

325 AYER ROAD

HARVARD, MA

FOR LEASE | 17,485 SF FLEX BUILDING ON 4.74 ACRES

HUNTER ROBERTS
NICHOLAS STUBBLEBINE

714.478.7993
978.202.0167

hroberts@stubblebinecompany.com
nick@stubblebinecompany.com



THE
STUBBLEBINE
COMPANY

CORFAC INTERNATIONAL

PROPERTY SUMMARY



PROPERTY DESCRIPTION

85,762 SF Flex Building on 4.74 Acres
17,485 SF Available: Subdividable

PROPERTY HIGHLIGHTS

- Subdividable: 1,584 – 4,396 SF Units
- 1.4 Miles to Route 2

AVAILABLE UNITS	SIZES
C-102/106R: (Warehouse)	4,396 SF
A-121/122: (Retail)	3,362 SF
A-110/119/120: (Retail)	3,090 SF
A-116: (R&D/Flex)	2,901 SF
B-120: (Office)	2,152 SF
B-113: (Office)	1,584 SF

PROPERTY SPECIFICATIONS

Building Size:	85,762 SF
Available SF:	17,485 SF (Subdivides)
Lot Size:	4.74 Acres
Lease Rate:	Market

DEMOGRAPHICS	3 MILES	5 MILES	10 MILES
Total Households	5,246	13,533	74,213
Total Population	14,073	37,417	198,746
Average HH Income	\$180,381	\$190,993	\$179,316

C-102 / C-106R



C-102 / C-106R



A-121 / A-122



A-119 / A-120



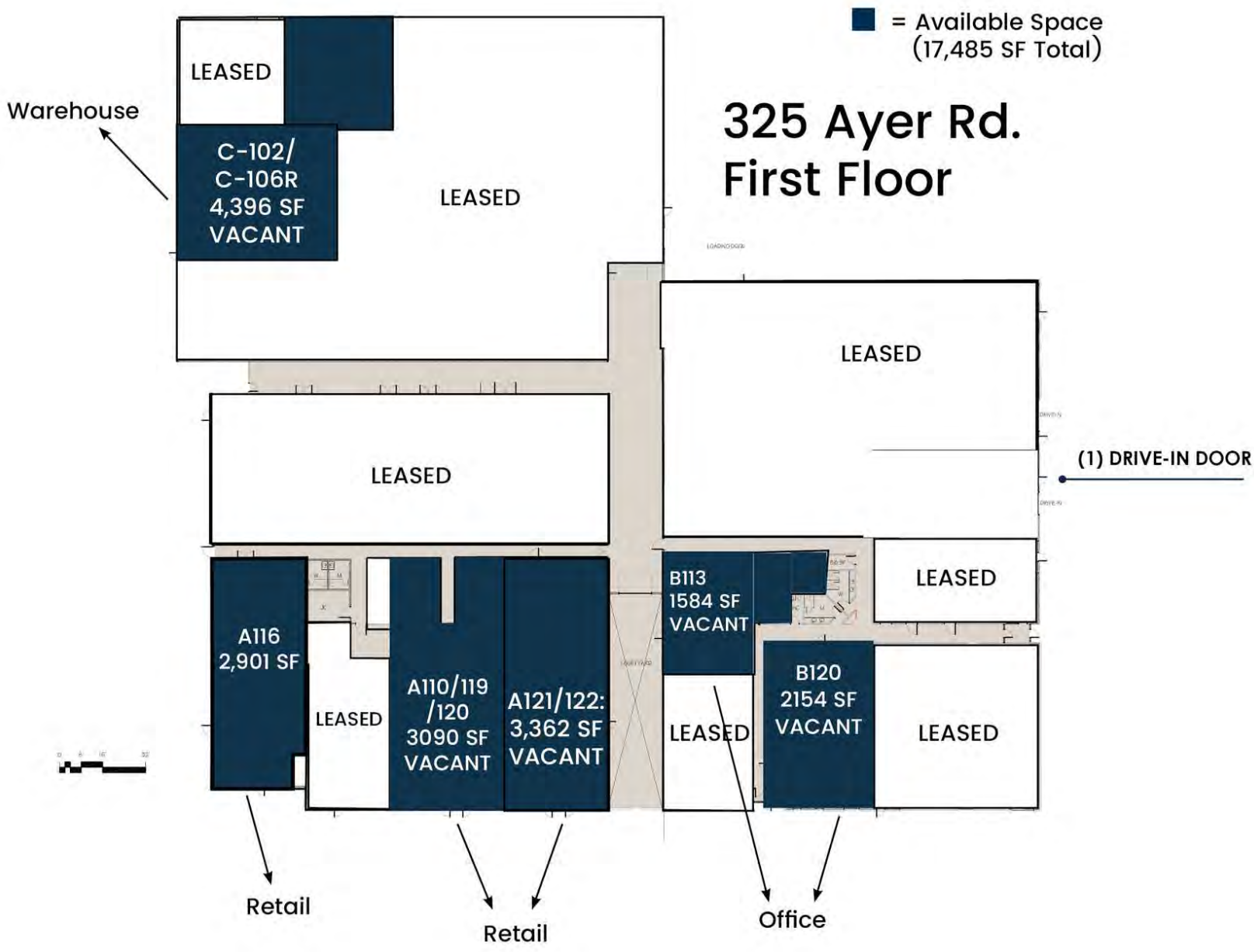

LOCATION MAP

2A

1 MILE
2 MIN



5.3 MILES
7 MIN

DEVENS

1 MILE
2 MIN

2

1.5 MILES
3 MIN



9.4 MILES
11 MIN

LITTLETON

5.9 MILES
9 MIN

111

1.8 MILES
5 MIN



LITTLETON



DEVENS

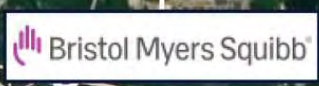

HARVARD

111

2

2A



325 AYER ROAD

HARVARD, MA

FOR LEASE | 17,485 SF FLEX BUILDING ON 4.74 ACRES

HUNTER ROBERTS

714.478.7993

hroberts@stubblebinecompany.com

NICHOLAS STUBBLEBINE

978.202.0167

nick@stubblebinecompany.com

We obtained the information above from sources we believe to be reliable. However, we have not verified its accuracy and make no guarantee, warranty or representation about it. It is submitted subject to the possibility of errors, omissions, change of price, rental or other conditions, prior sale, lease or financing, or withdrawal without notice. We include projections, opinions, assumptions or estimates for example only, and they may not represent current or future performance of the property. You and your tax and legal advisors should conduct your own investigation of the property and transaction.



THE
STUBBLEBINE
COMPANY

CORFAC INTERNATIONAL