

53 MILLBROOK STREET

WORCESTER, MA



123,548 SF

MANUFACTURING BUILDING ON
4.72 ACRES FOR LEASE

CONTACT:

DAVID STUBBLEBINE 617.592.3391
JAMES STUBBLEBINE 617.592.3388
DAVID SKINNER 617.999.0057
AARON M. RACETTE 774.279.5184

DAVID@STUBBLEBINECOMPANY.COM
JAMES@STUBBLEBINECOMPANY.COM
DSKINNER@STUBBLEBINECOMPANY.COM
AARON@STUBBLEBINECOMPANY.COM

EXCLUSIVE OFFERING



THE
STUBBLEBINE
COMPANY

CORFAC INTERNATIONAL

PROPERTY SUMMARY



PROPERTY SPECIFICATIONS

BUILDING SIZE	123,548 SF
FOOTPRINT	98,782 SF
SECOND FLOOR	24,766 SF
SUBDIVISION	TO 60,000 SF
LAND AREA	4.72 ACRES
CEILING HEIGHT	21'8" UNDER BAR JOISTS AND 25'6" IN 6,912 SF AREA
LOADING	SIX (6) TAILBOARD DOCKS
COLUMN SPACING	24' X 40' AND 24' X 48' IN 6,912 SF AREA
ZONING	MG-1
HEAT	GAS
ELECTRIC	4,000 AMPS; 480 V; 3 P 4 W
CONSTRUCTION	CONCRETE BLOCK AND STEEL
RAIL	ACTIVE P&W RAIL 2 RAIL SPURS & 5 RAIL SIDE LOADING DOORS

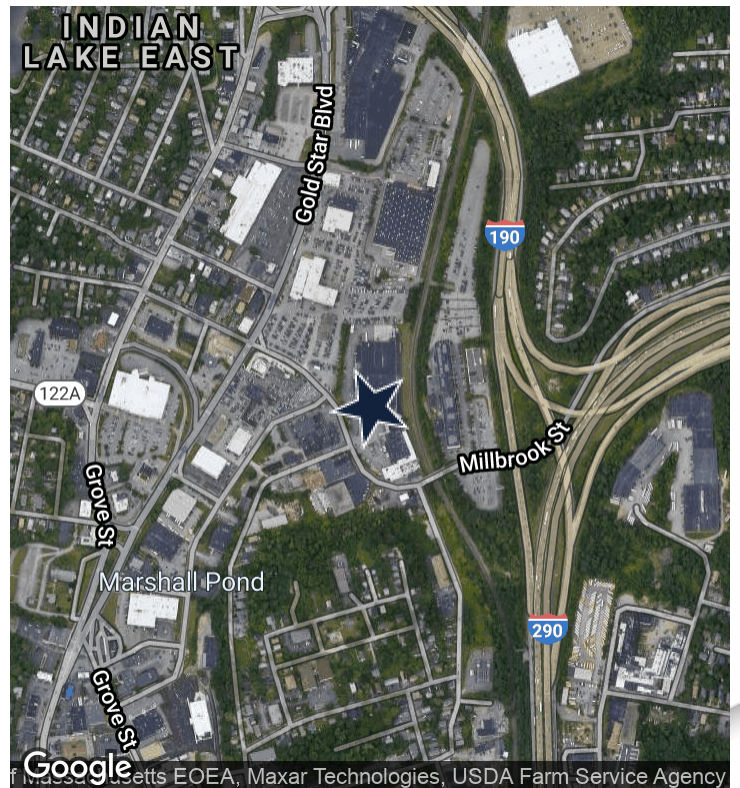

FLOOR PLANS

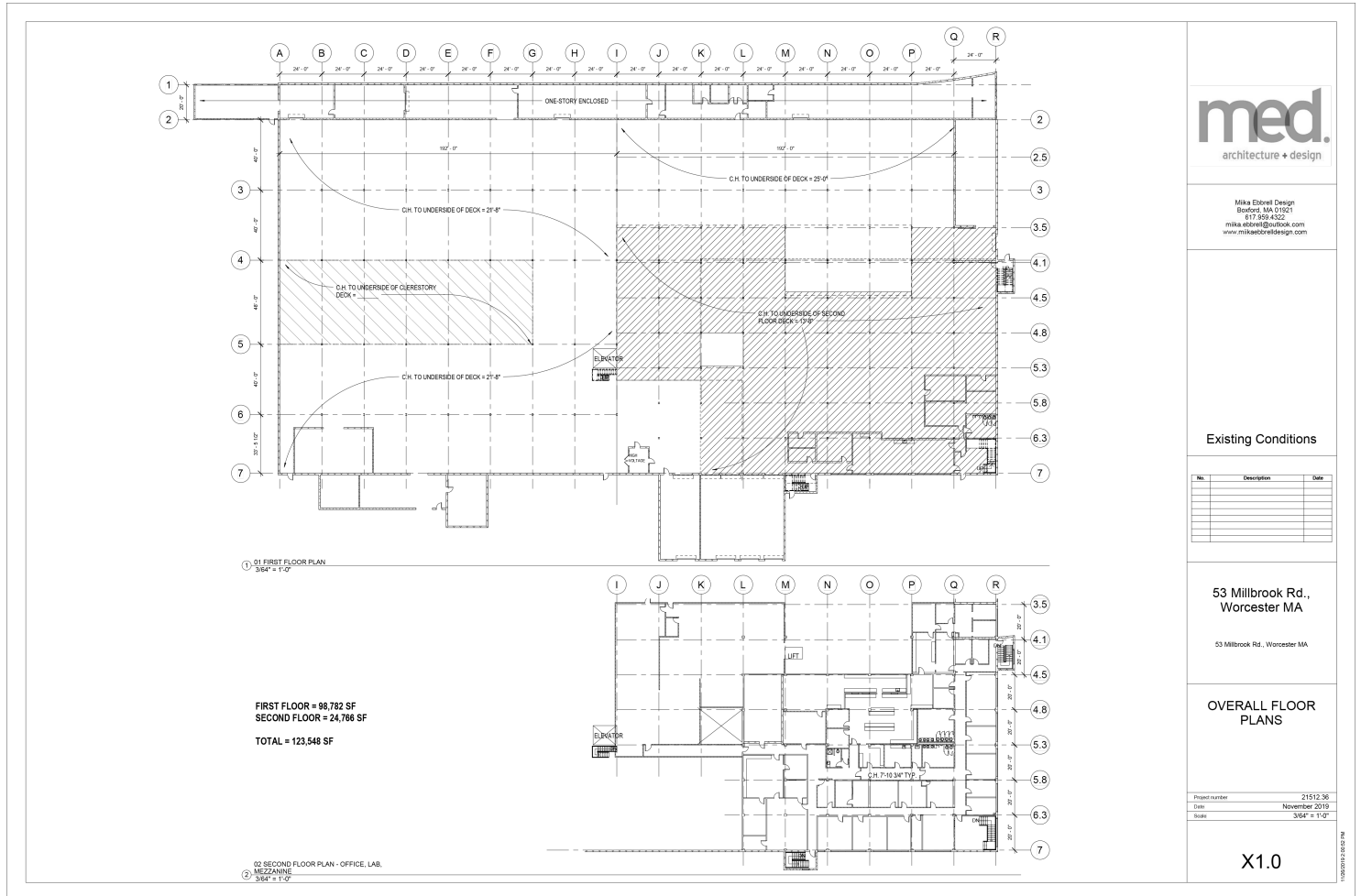

LOCATION MAPS

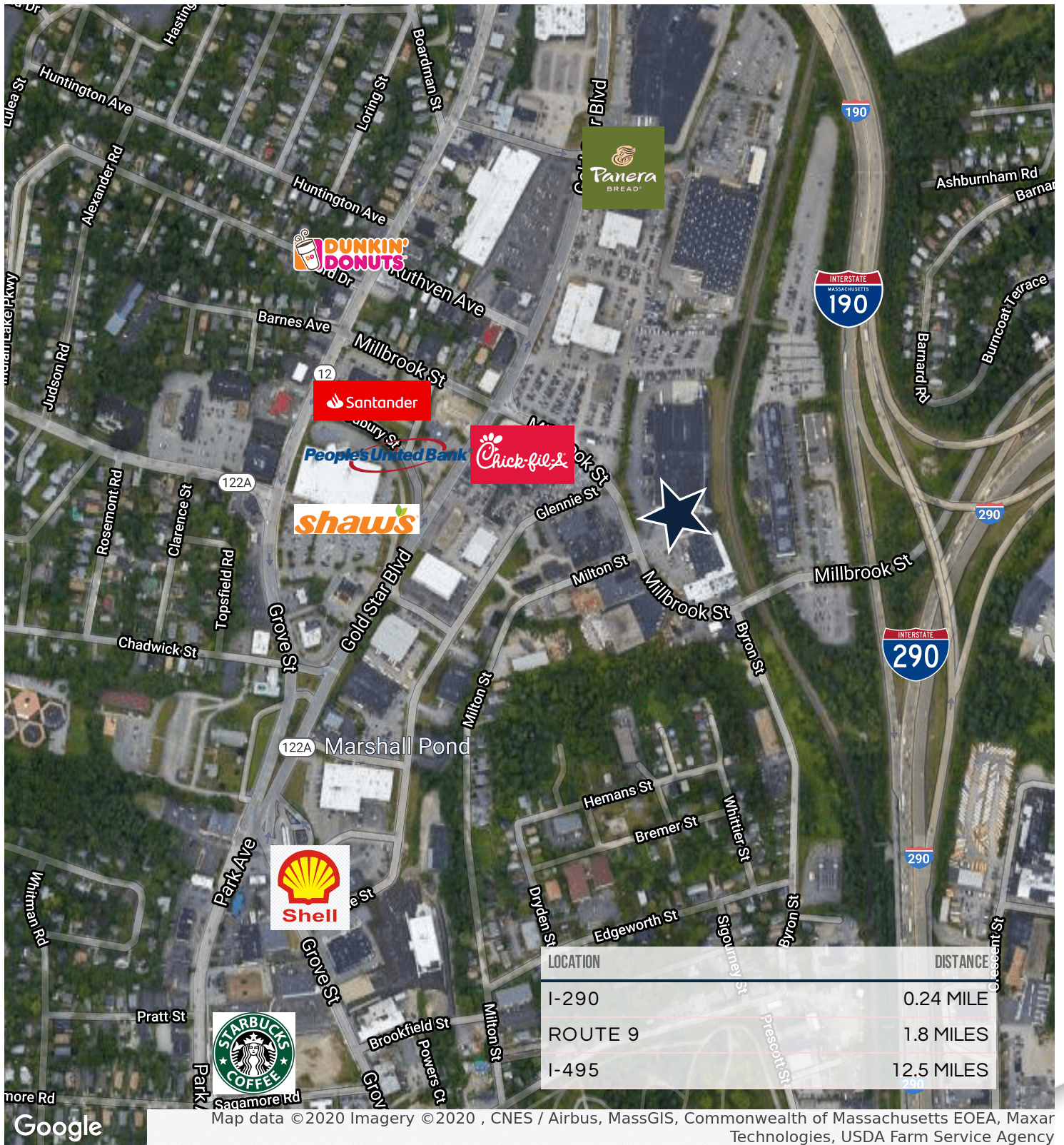

Map data ©2020 Imagery ©2020, CNES / Airbus, MassGIS, Commonwealth of Massachusetts EOE, Maxar Technologies, USDA Farm Service Agency