

53 MILLBROOK STREET

WORCESTER, MA



123,548 SF

MANUFACTURING BUILDING
ON 4.72 ACRES FOR LEASE

- ACTIVE P&W RAIL: 2 SPURS
- LOCATED JUST OFF OF I-290

CONTACT:

DAVID STUBBLEBINE 617.592.3391
JAMES STUBBLEBINE 617.592.3388
DAVID SKINNER 617.999.0057
AARON M. RACETTE 774.279.5184

DAVID@STUBBLEBINECOMPANY.COM
JAMES@STUBBLEBINECOMPANY.COM
DSKINNER@STUBBLEBINECOMPANY.COM
AARON@STUBBLEBINECOMPANY.COM

EXCLUSIVE OFFERING



THE
STUBBLEBINE
COMPANY

CORFAC INTERNATIONAL

PROPERTY SUMMARY



PROPERTY SPECIFICATIONS

| | |
|----------------|---|
| BUILDING SIZE | 123,548 SF |
| FOOTPRINT | 98,782 SF |
| SECOND FLOOR | 24,766 SF |
| SUBDIVISION | TO 60,000 SF |
| LAND AREA | 4.72 ACRES |
| CEILING HEIGHT | 19' - 22' UNDER BAR JOISTS |
| LOADING | SIX (6) TAILBOARD DOCKS |
| COLUMN SPACING | MOSTLY 24' 40' |
| ZONING | MG-1 |
| HEAT | GAS |
| CONSTRUCTION | CONCRETE BLOCK AND STEEL WITH A BRICK FACADE |
| RAIL | ACTIVE P&W RAIL TWO (2) RAIL SPURS FIVE (5) RAIL SIDE LOADING DOORS |

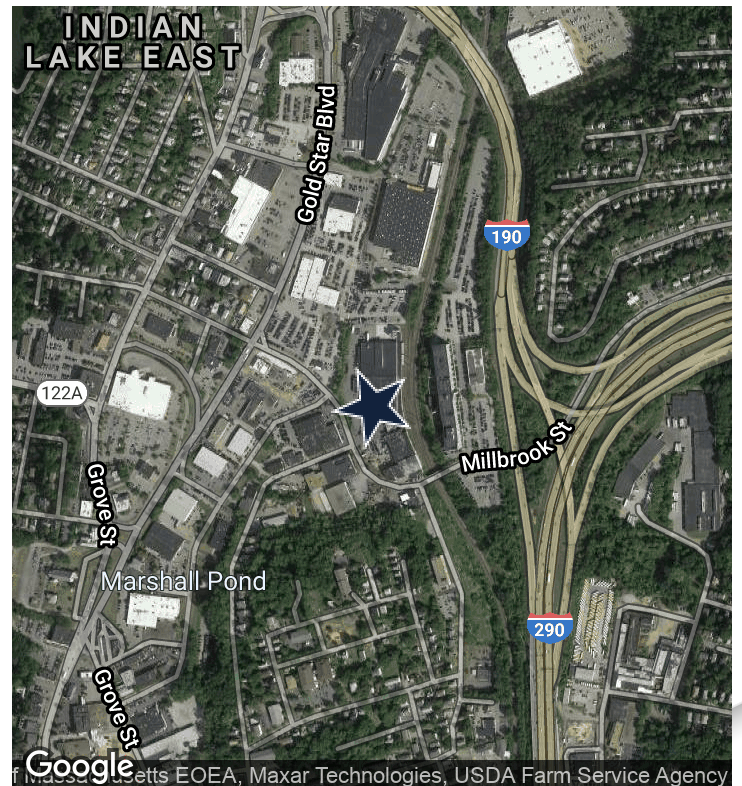

FLOOR PLANS

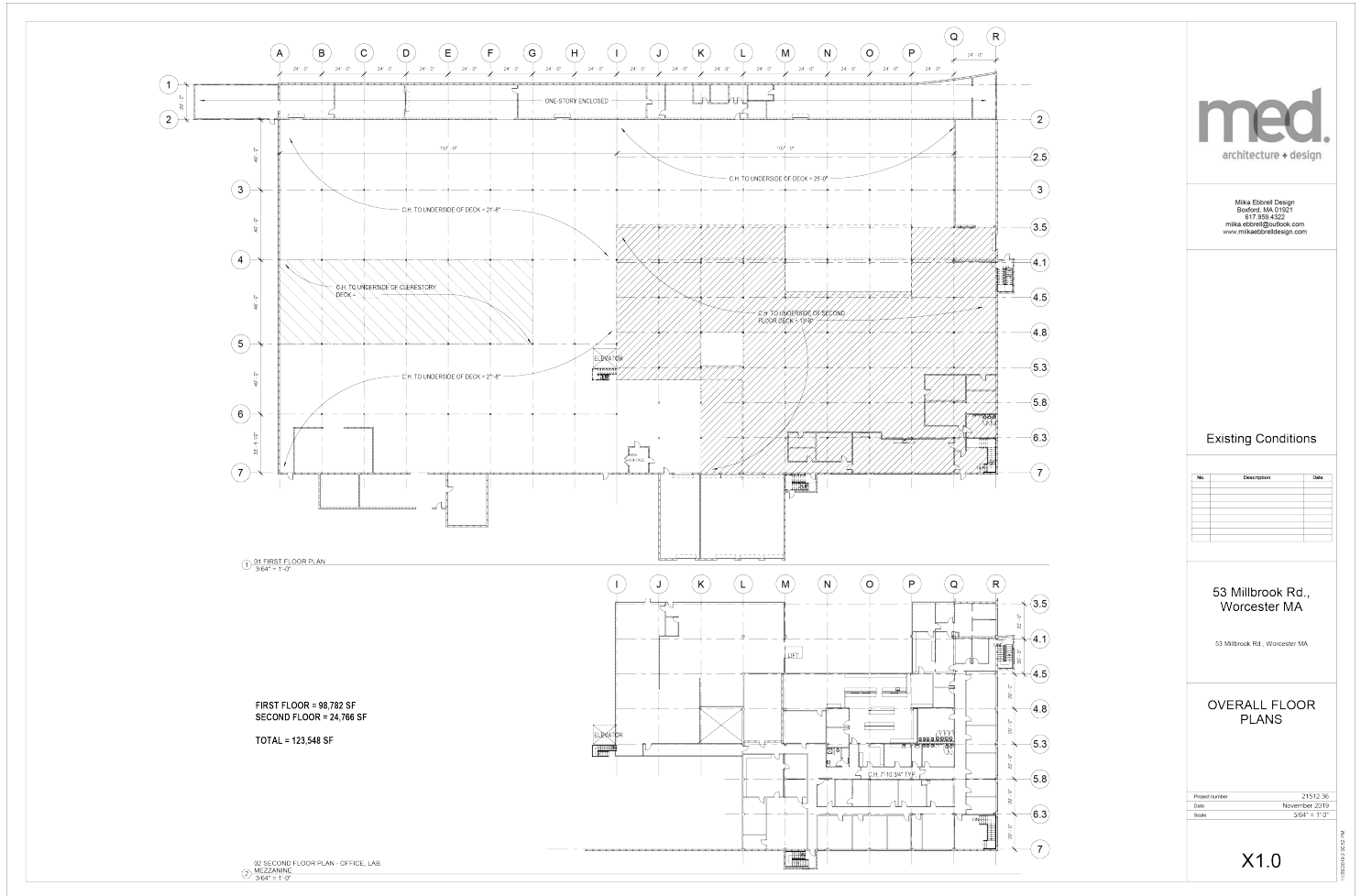

med.
architecture + design

Mika Ebbel Design
Boston, MA 01921
617.865.6322
mika.ebbel@outlook.com
www.mikaebbeldesign.com

Existing Conditions

| No. | Description | Date |
|-----|-------------|------|
| | | |
| | | |
| | | |
| | | |
| | | |
| | | |

53 Millbrook Rd., Worcester MA
53 Millbrook Rd., Worcester MA

OVERALL FLOOR PLANS

| | |
|----------------|---------------|
| Project number | 21512-36 |
| Date | November 2018 |
| Scale | 3/8" = 1'-0" |

X1.0

LOCATION MAPS

