

FOR
LEASE

95 AUBUCHON DRIVE WESTMINSTER, MA



412,360 SF WORLD-CLASS DISTRIBUTION BUILDING ON 33 ACRES

» As the exclusive agent, The Stubblebine Company is pleased to offer 95 Aubuchon Drive, Westminster, MA:

- Large 32.8 Acre Lot (up to 53 Acres Available)
- Expandable up to 600,000 SF
- Outstanding highway visibility from Route 2
- Easy access to Route 2, I-495 and I-90
- 39 tailboard and 3 drive-in doors
- 26' ceiling height
- ESR Sprinklers
- All Utilities
- Subdividable

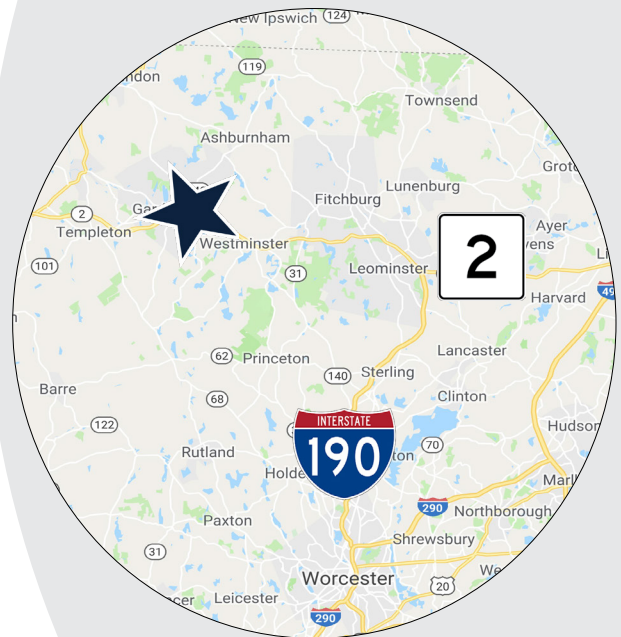

EXCLUSIVE LISTING AGENT
THE STUBBLEBINE COMPANY
CORFAC INTERNATIONAL



PROPERTY SPECIFICATIONS

BUILDING SIZE:	412,360 SF
SPACE AVAILABLE:	412,360 SF
FOOTPRINT:	262,000 SF
LAND AREA:	32.8 ACRES (UP TO 55 ACRES AVAILABLE)
LOADING DOCKS:	THIRTY NINE (39) KELLY DOCK DOORS THREE (3) DRIVE-IN DOORS
WATER & SEWER:	CITY
PARKING:	180 CARS, 20 TRACTORS, 50 TRAILERS, POTENTIAL PARKING 650+ CARS
ZONING:	INDUSTRIAL 1
CEILING HEIGHT:	MAIN LEVEL: 26' MEZZANINE: 12' LOWER LEVEL: 13'
SPRINKLER SYSTEM:	ESFR
YEAR BUILT/EXPANSION:	1988
HEAT:	GAS
COLUMNS:	30' X 30'
POWER:	1,200 - 2,000 AMPS HEAVY; 500 KW SOLAR/ELECTRICITY
OPEX/TAXES:	\$1.05 +/- PER SF (2019)
ZONING:	INDUSTRIAL



EXCLUSIVE LISTING AGENT
THE STUBBLEBINE COMPANY
CORFAC INTERNATIONAL

BUILDING OPTIONS

Bldg	Main SF	Mezzanine SF	Total SF	Lower SF	SF per Building
1	80,000	24,000	104,000	-	104,000
2	79,000	16,000	95,000	49,858	144,858
3	102,400	30,720	133,120	-	133,120
Total	261,400	70,720	332,120	49,858	381,978
2nd Floor Office (optional)		-	19,202 (Building1)	11,543	30,745



EXCLUSIVE LISTING AGENT
 THE STUBBLEBINE COMPANY
 CORFAC INTERNATIONAL

BUILDING PHOTOS



PARKING
180 CARS
20 TRACTORS
50 TRAILERS

POTENTIAL PARKING
650+ CARS



EXCLUSIVE LISTING AGENT
THE STUBBLEBINE COMPANY
CORFAC INTERNATIONAL

FLOOR PLAN

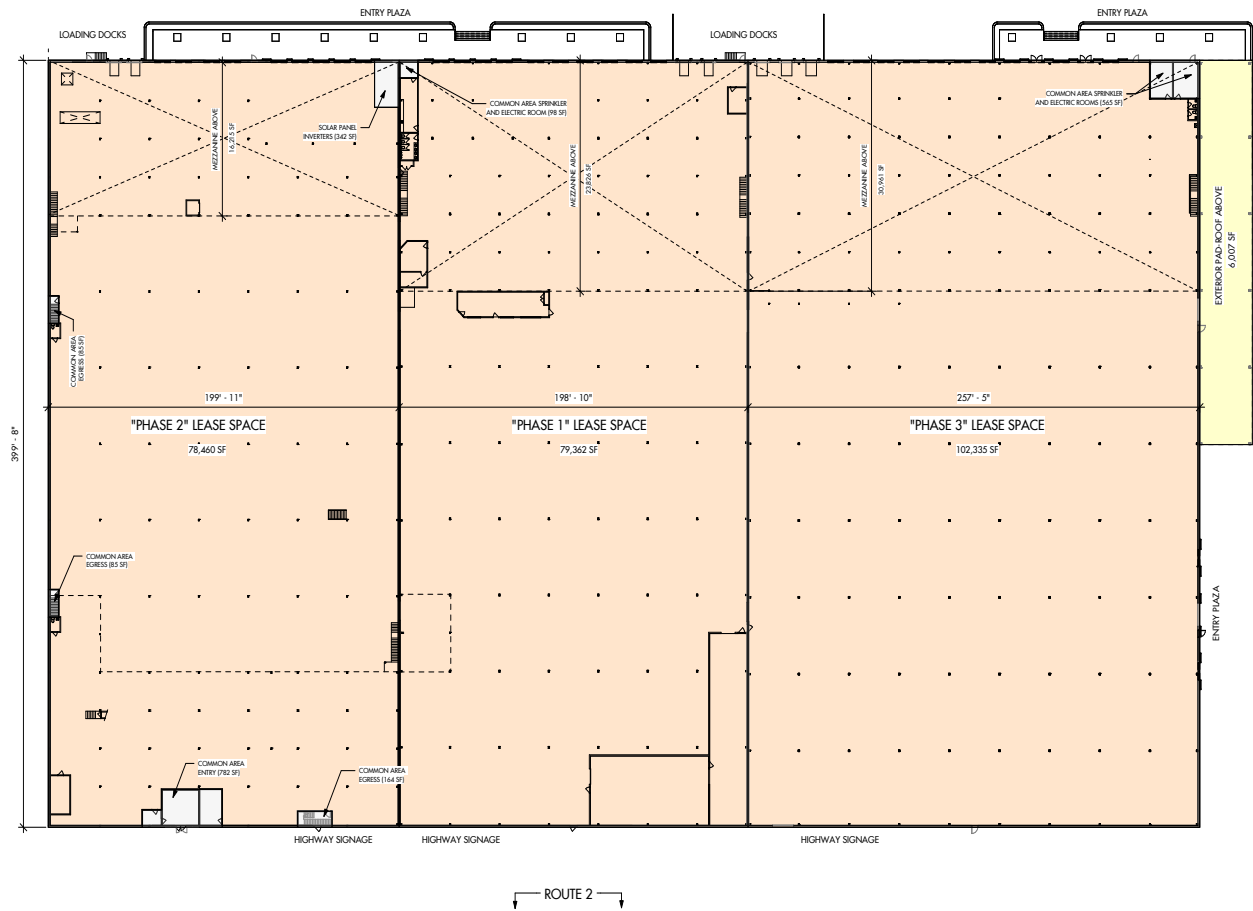

EXCLUSIVE LISTING AGENT
THE STUBBLEBINE COMPANY
CORFAC INTERNATIONAL

CORPORATE NEIGHBORS



LOCAL AMENITIES



EXCLUSIVE LISTING AGENT
THE STUBBLEBINE COMPANY
CORFAC INTERNATIONAL

LOCATION

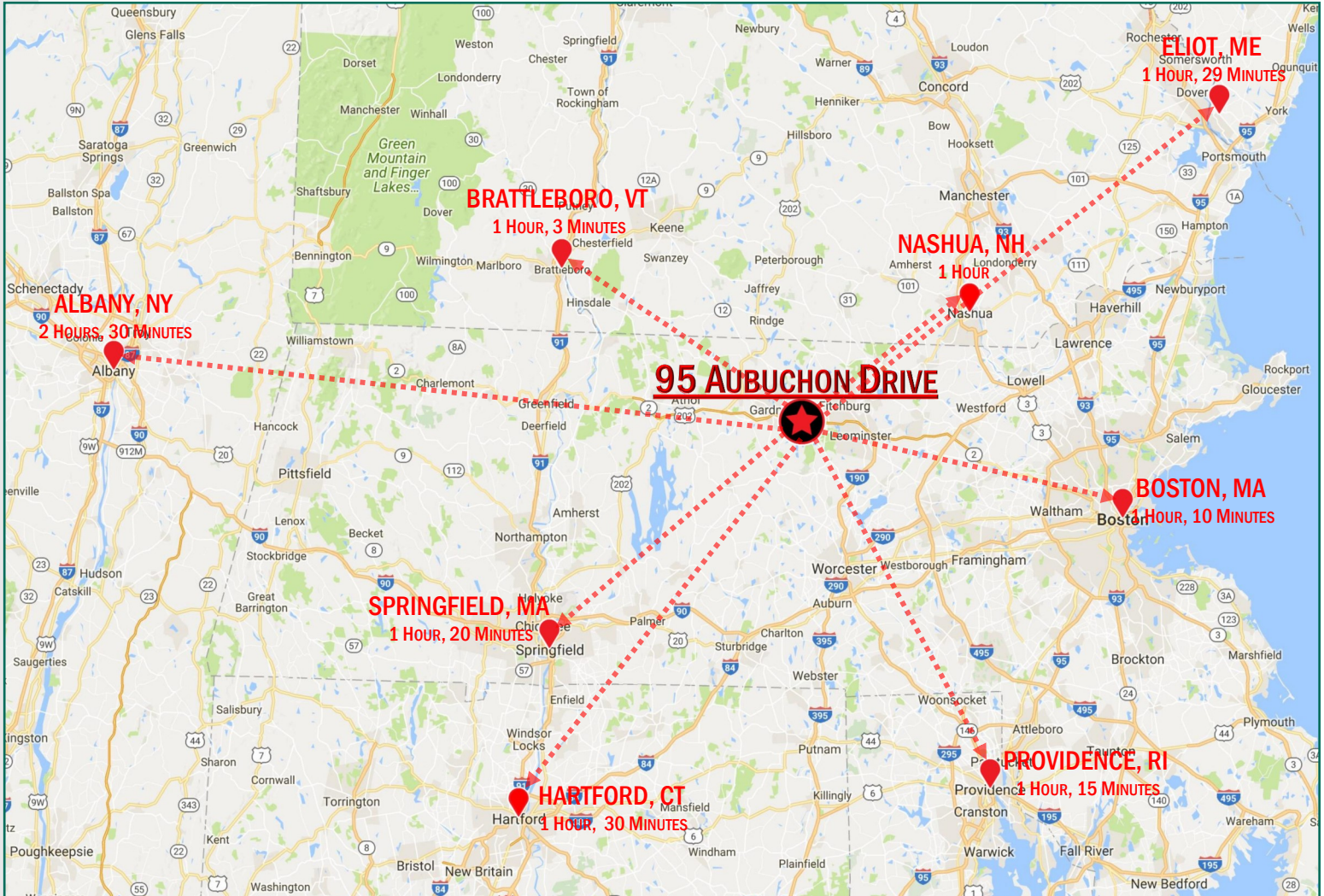

EXCLUSIVE LISTING AGENT
 THE STUBBLEBINE COMPANY
 CORFAC INTERNATIONAL

CONTACT:

DAVID STUBBLEBINE 617-592-3391

JAMES STUBBLEBINE 617-592-3388

- 1.5 minutes to Route 2
- 27 minutes to Route 495
- 45 minutes to Route 90
- 20.2 miles to Devens
- 24 miles to Worcester
- 50 miles to Boston